

FIADA IMPAR — 1º PAVIMENTO (BLOCO A)

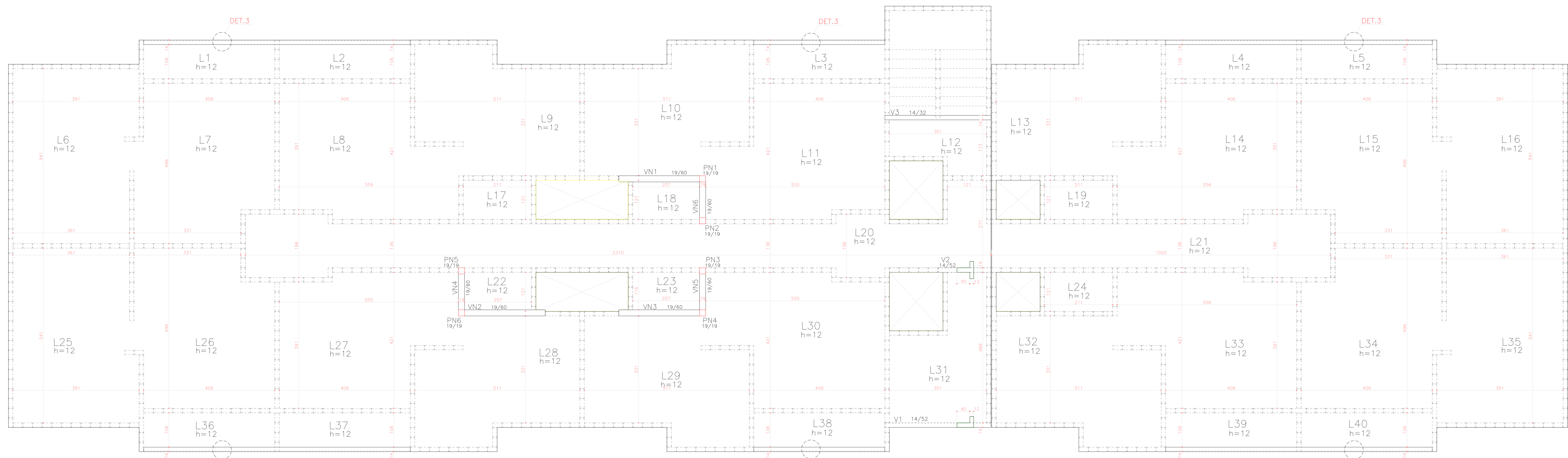

FORMAS — 2º PAVIMENTO (BLOCO A)
EL=100,07 m

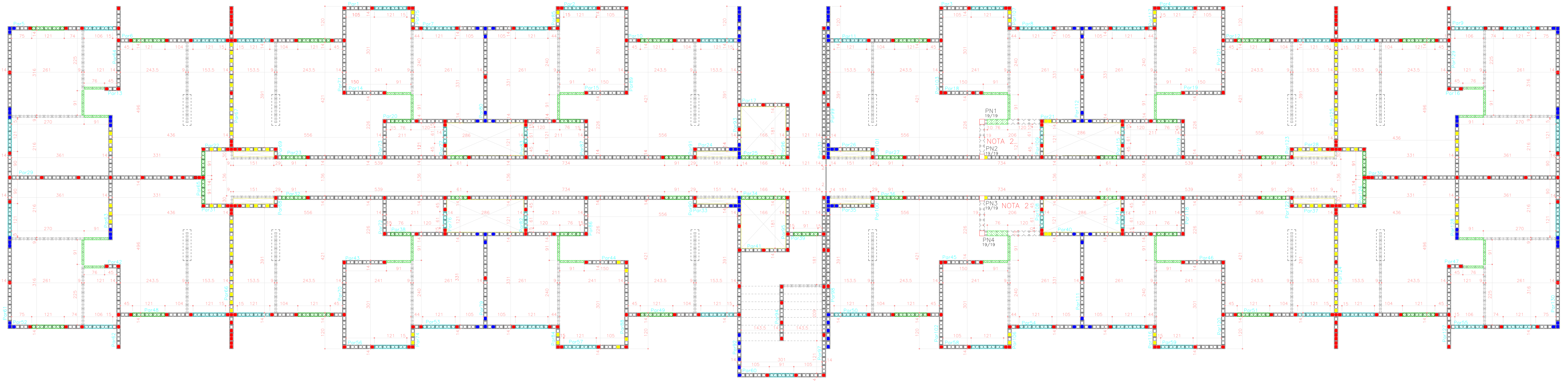

FIADA IMPAR - 1° PAVIMENTO (BLOCO B)

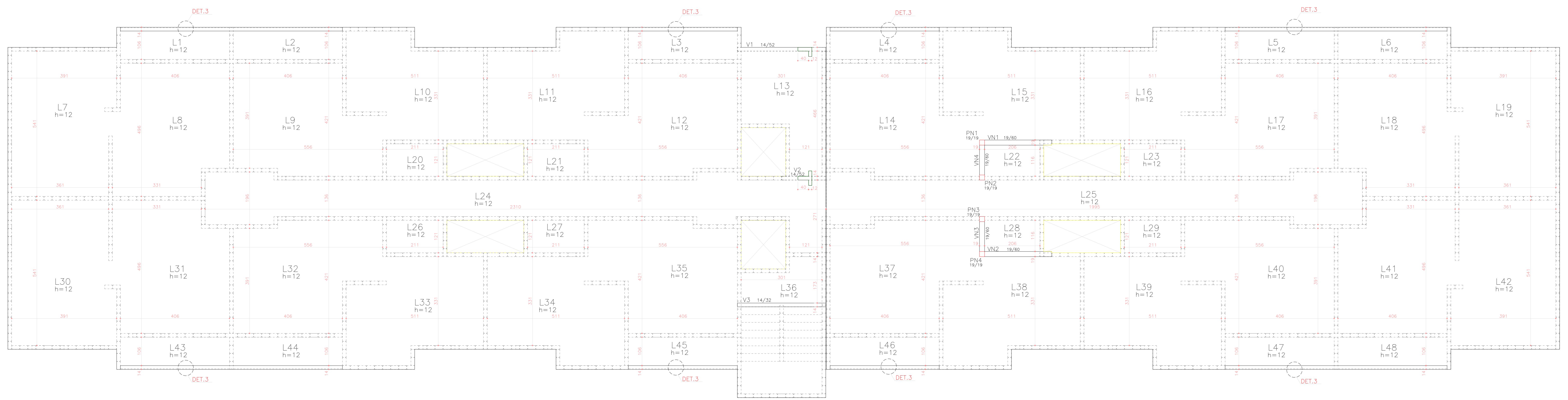

FORMAS - 2° PAVIMENTO (BLOCO B)
COTA EL= 100,07m